

Sheaves

5V SERIES 3 GROOVE/QD

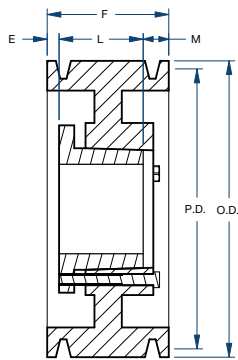

BLACKSTAR®



Type A

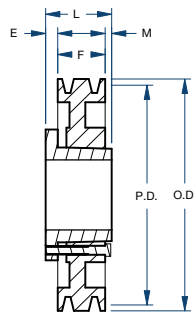

Type C

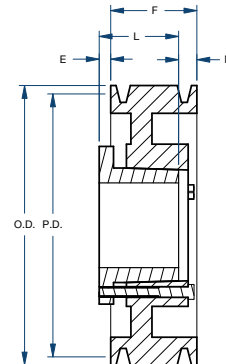

Type D

Part Number	Bushing	Bore Range	Type	Diameter (in)		Dimensions (in)				Weight less Bushing (lbs)
				Pitch	Outside	E	F	L	M	
3-5V440SDS	SDS	1/2 – 2	E	4.30	4.40	1-23/32	2-3/8	1-5/16	21/32	6.5
3-5V465SDS	SDS	1/2 – 2	E	4.55	4.65	1-23/32	2-3/8	1-5/16	21/32	7.6
3-5V490SDS	SDS	1/2 – 2	A	4.80	4.90	13/32	2-3/8	1-5/16	21/32	7.8
3-5V520SDS	SDS	1/2 – 2	A	5.10	5.20	13/32	2-3/8	1-5/16	21/32	8.0
3-5V550SDS	SDS	1/2 – 2	A	5.40	5.50	13/32	2-3/8	1-5/16	21/32	8.2
3-5V590SDS	SDS	1/2 – 2	A	5.80	5.90	13/32	2-3/8	1-5/16	21/32	8.6
3-5V630SK	SK	1/2 – 2-5/8	A	6.20	6.30	9/32	2-3/8	1-15/16	5/32	10.4
3-5V670SK	SK	1/2 – 2-5/8	A	6.60	6.70	9/32	2-3/8	1-15/16	5/32	11.7
3-5V710SF	SF	1/2 – 2-15/16	A	7.00	7.10	5/32	2-3/8	2-1/16	5/32	12.7
3-5V750SF	SF	1/2 – 2-15/16	A	7.40	7.50	5/32	2-3/8	2-1/16	5/32	15.0
3-5V800SF	SF	1/2 – 2-15/16	A	7.90	8.00	5/32	2-3/8	2-1/16	5/32	16.5
3-5V850SF	SF	1/2 – 2-15/16	A	8.40	8.50	5/32	2-3/8	2-1/16	5/32	18.0
3-5V900SF	SF	1/2 – 2-15/16	A	8.90	9.00	5/32	2-3/8	2-1/16	5/32	19.8
3-5V925SF	SF	1/2 – 2-15/16	A	9.15	9.25	5/32	2-3/8	2-1/16	5/32	20.7
3-5V975SF	SF	1/2 – 2-15/16	A	9.65	9.75	5/32	2-3/8	2-1/16	5/32	22.6
3-5V1030SF	SF	1/2 – 2-15/16	A	10.20	10.30	5/32	2-3/8	2-1/16	5/32	24.6
3-5V1090SF	SF	1/2 – 2-15/16	A	10.80	10.90	5/32	2-3/8	2-1/16	5/32	26.7
3-5V1130SF	SF	1/2 – 2-15/16	A	11.20	11.30	5/32	2-3/8	2-1/16	5/32	28.2
3-5V1180SF	SF	1/2 – 2-15/16	A	11.70	11.80	5/32	2-3/8	2-1/16	5/32	29.7
3-5V1250E	E	7/8 – 3-1/2	D	12.40	12.50	13/32	2-3/8	2-3/4	1/32	34.0
3-5V1320E	E	7/8 – 3-1/2	D	13.10	13.20	13/32	2-3/8	2-3/4	1/32	35.0
3-5V1400E	E	7/8 – 3-1/2	D	13.90	14.00	13/32	2-3/8	2-3/4	1/32	37.0
3-5V1500E	E	7/8 – 3-1/2	D	14.90	15.00	13/32	2-3/8	2-3/4	1/32	38.0
3-5V1600E	E	7/8 – 3-1/2	D	15.90	16.00	13/32	2-3/8	2-3/4	1/32	39.2
3-5V1870E	E	7/8 – 3-1/2	D	18.60	18.70	13/32	2-3/8	2-3/4	1/32	47.2
3-5V2120E	E	7/8 – 3-1/2	D	21.10	21.20	13/32	2-3/8	2-3/4	1/32	55.0
3-5V2360E	E	7/8 – 3-1/2	D	23.50	23.60	13/32	2-3/8	2-3/4	1/32	70.2
3-5V2800E	E	7/8 – 3-1/2	D	27.90	28.00	13/32	2-3/8	2-3/4	1/32	86.5
3-5V3150F	F	1 – 4	C	31.40	31.50	25/32	2-3/8	3-3/4	19/32	116.0
3-5V3750F	F	1 – 4	C	37.40	37.50	25/32	2-3/8	3-3/4	19/32	141.0
3-5V5000F	F	1 – 4	C	49.90	50.00	25/32	2-3/8	3-3/4	19/32	211.0